



Homestead Pear Tree Lane

Hempstead, ME7 3PR

Price guide £500,000 to £525,000



PRICE GUIDE £500,000 to £525,000. A unique bungalow offering an abundance of potential and space to create your forever home. Accommodation currently consists of a large front to back, dual aspect lounge, dining room, kitchen, utility room, three good sized bedrooms and large five piece bathroom! The frontage, car port and generous sized 23' garage provide multiple parking options and the rear garden offers both privacy, and a sunny, southerly aspect. Hempstead Valley shopping is located close by with it's array of shops and eateries. Motorway access is also conveniently a short drive away, as are numerous schools, adding to the appeal. A superb and popular location, NO CHAIN.



Entrance Door

Hallway

Dining Room

9'8 x 8'3 (2.95m x 2.51m)

Kitchen

13'5 x 8'3 (4.09m x 2.51m)

Utility Room

9'3 x 8'3 (2.82m x 2.51m)

Lounge

19'8 x 13'8 (5.99m x 4.17m)

Inner Hallway

Bedroom 1

11'9 x 11'10 inc wardrobe depth (3.58m x 3.61m inc wardrobe depth)

Bedroom 3

9'10 x 8'6 (3.00m x 2.59m)

Bathroom

9'9 x 8'6 (2.97m x 2.59m)

Bedroom 2

15'8 x 8'6 (4.78m x 2.59m)

En-suite

Garden

55' x 35' apx (16.76m x 10.67m apx)

Garage

23'2 x 8'9 (7.06m x 2.67m)

Driveway & Carport

Important Notice -

Area Map

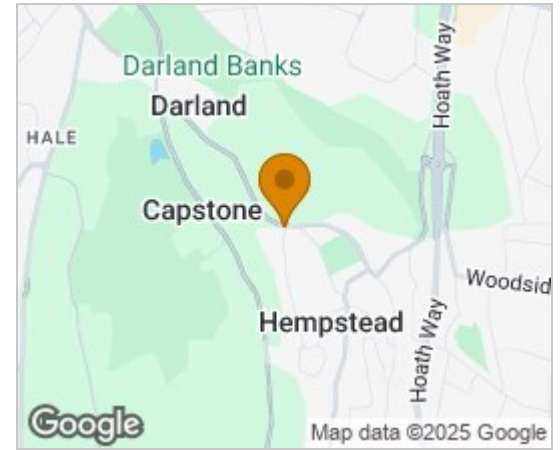

Floor Plans

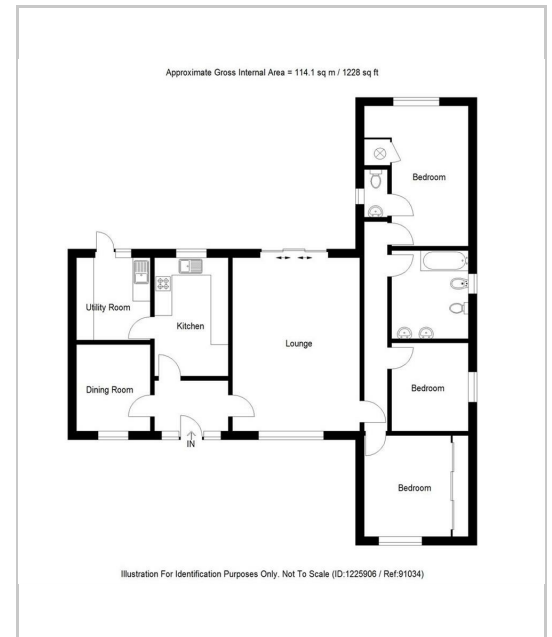

Energy Efficiency Graph

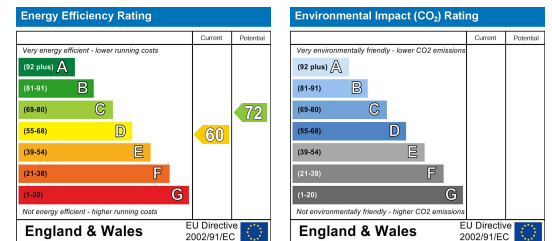

These particulars, whilst believed to be accurate are set out as a general outline only for guidance and do not constitute any part of an offer or contract. Intending purchasers should not rely on them as statements of representation of fact, but must satisfy themselves by inspection or otherwise as to their accuracy. No person in this firm's employment has the authority to make or give any representation or warranty in respect of the property.